

VA-THERM

A new development with many benefits

Designed for doors and partition walls
for outside area

NEW!!!



Technical Performance:
in accordance with EN 10077-2

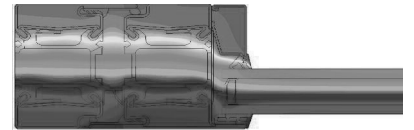

$U_f = 1.9 \text{ W/m}^2\text{K}$
In standard version

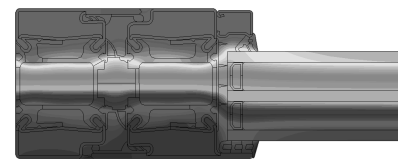

$U_f = 1.2 \text{ W/m}^2\text{K}$
In reinforced version

U_d 1.6 with 2-panel ISO-glass U_g 1.1
 U_d 0.8 with 3-panel ISO-glass U_g 0.5 and additional components

General data:

- Overall depth 85mm
- Width for
 - Wall connection profile 45 mm or 70 mm
 - Transom and mullion 65mm or 90mm
 - Door frame (Wing profile and frame profile) 132mm
- Inside and outside flush
- Glass thickness from 21mm to 58mm possible

**Patent
applied**